

10dB Attenuator, DC-2700 MHz,10W,N Male/Female

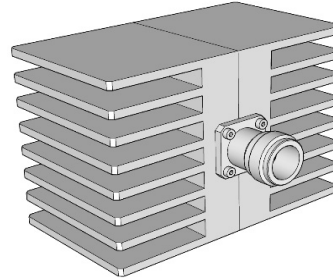

Specifications

General Specification

Color	Silver
Inner Contact Plating	Silver
Interface	N male/female
Outer Contact Plating	Tri metal
Housing	Anodized aluminium

Dimensions

Length*Width*Height	80 mm * 55 mm * 89.5 mm
----------------------------	-------------------------

Weights

Weight, net	0.29 kg
--------------------	---------

Electrical Specification

Power Rating, Max	10 W
Peak power	1 kW
Impedance, nominal	50 ohm
Frequency Range	DC-2700 MHz
Attenuation Values	10 dB
Attenuation Accuracy	± 1 dB
VSWR, Max	1.25

Environmental Specification

Temperature Range	-35 °C to +85 °C
--------------------------	------------------